

JAY FLIGHT OCTANE

TRAVEL TRAILER TOY HAULERS

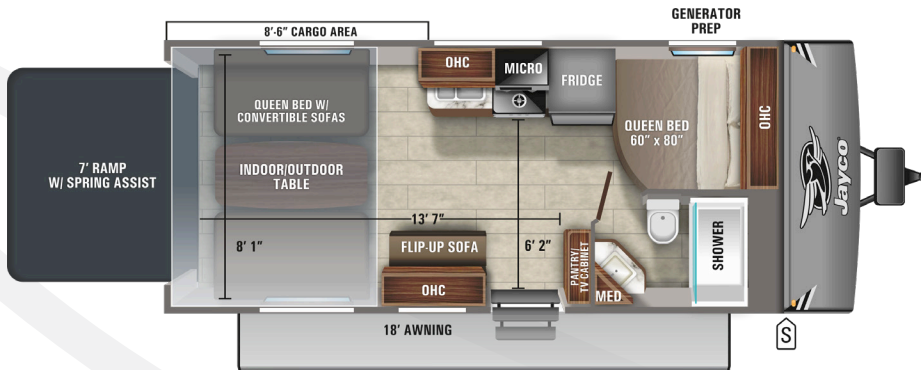

Ext. Lgth: 26' 6" Weight: 5,655 lbs. Hitch: 845 lbs.

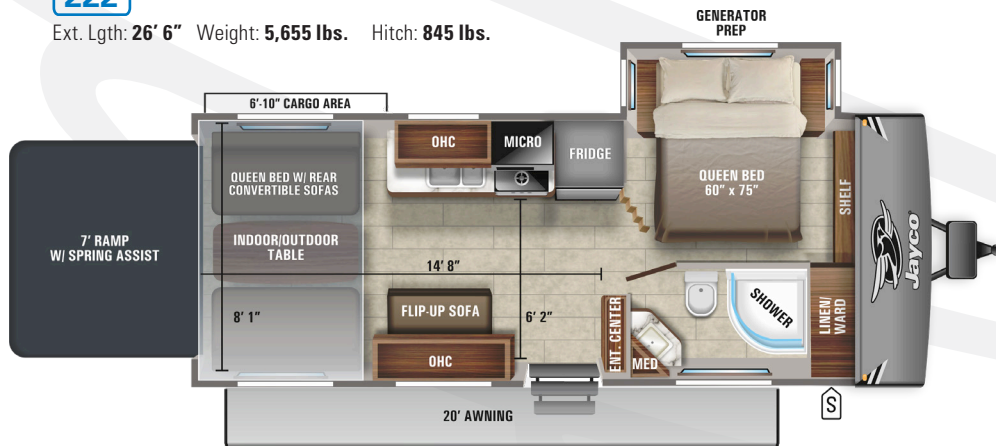

Ext. Lgth: 29' 0" Weight: 6,535 lbs. Hitch: 1,075 lbs.

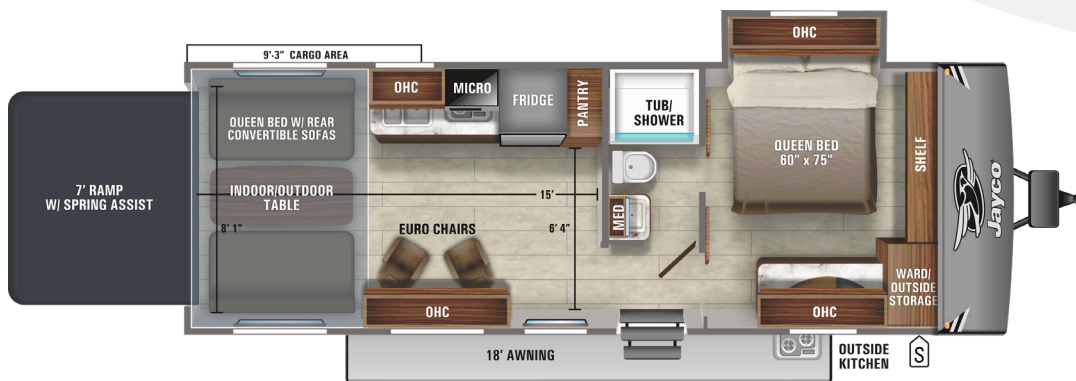

Ext. Lgth: 32' 0" Weight: TBD Hitch: TBD

STANDARDS & OPTIONS

STANDARD EXTERIOR EQUIPMENT

- Fully integrated A-frame
- Keyed-Alike™ lockable baggage doors
- G20 dark tinted, safety-glass windows
- 30-amp power service
- 13,500 BTU roof-mounted A/C
- Water heater bypass system
- Water system winterization kit
- LED exterior lights
- (2) 20 lb. LP bottles with cover
- Electric tongue jack
- Heated, enclosed underbelly

STANDARD INTERIOR EQUIPMENT

- Auto ignition furnace with wall thermostat
- Command center (select models)
- USB charging port
- Vinyl flooring throughout
- LED interior lights
- Solid hardwood cabinet doors
- Heavy-duty, 75 lb., full-extension, steel ball-bearing drawer guides
- Deep double bowl, 50/50 sink with cutting board cover (1)
- Flush-mounted 3-burner stovetop with glass cover and oven
- High-rise kitchen faucet
- A/C ducts in front bedroom (select models)
- Gas-strutted under-bed storage (select models)
- Power queen beds with rear convertible sofa and folding arm rests with cup holders
- ABS tub/shower surround
- Bathroom medicine cabinet
- Bathroom exhaust vent

RAMP AND CARGO EQUIPMENT

- Non-skid ramp door, 3,000 lb. ramp capacity, 96 in. wide ramp door opening
- High intensity rear ramp lights (2)
- Spring-assist ramp door
- Garage vent ports
- Overhead storage cabinets

CUSTOMER VALUE PACKAGE (MANDATORY)

- Nitrogen-filled Goodyear® Endurance® tires (made in the USA)
- 102 in. wide-body construction (8' 6")
- Aluminum rims
- 6 gal. gas/electric DSI water heater
- Digital TV antenna
- I-Class™ cambered structural-steel I-beam frame
- Magnum Truss™ Roof System
- Self-adjusting electric brakes
- Spare tire and carrier
- Diamond plate rock guard
- Black tank flush
- LED taillights
- Bar-lock latches with keyed ramp door locks
- Stabilizer jacks (4)
- Exclusive designer exterior graphics package
- Ducted roof A/C (select models)
- Matching radius fiberglass front wrap and ramp door
- Roof mounted solar prep
- Garage and rear camera prep
- Power awning with LED lights
- Retractable screen wall

- JaySMART™ (Safety Markers And Reverse Travel) LED lighting (patent-pending)
- Generator prep
- Premium multimedia sound system with MP3/iPod input jacks and Bluetooth® connectivity
- Pleated night shades
- 2 in. block-foam floor, vacuum-bonded and laminated
- Garage D-rings mounted to steel frame
- Removable dinette table
- Overhead stainless steel microwave oven
- Seamless kitchen and bathroom countertops
- 8 cu. ft. double door refrigerator

OPTIONS

- Customer Value Package
- 15,000 BTU roof A/C
- Fiberglass sidewalls
- 40 gal. fuel station
- 50-amp service with 2nd A/C prep (select models)
- 2nd 13,500 BTU A/C in bedroom (select models)
- Ramp patio system
- Solar Power Package (100W roof solar panel & 30-amp digital controller)
- JAYCOMMAND™ "Smart RV" system with TPMS (Tire Pressure Monitoring System)
- 4,000W Onan® generator

FLOORPLAN	EXTERIOR TRAVEL LENGTH	EXTERIOR WIDTH	EXTERIOR HEIGHT (WITH A/C)	INTERIOR HEIGHT	UNLOADED VEHICLE WEIGHT	DRY HITCH WEIGHT	GVWR	CARGO CARRYING CAPACITY	FRESH WATER CAPACITY (INCLUDING WATER HEATER)	GRAY WASTE WATER CAPACITY	BLACK WASTE WATER CAPACITY	SLEEPING CAPACITY
222	26' 6"	8' 6"	11' 2"	7' 5"	5,655	845	8,250	2,595	86	39	39	5-6
255	29' 0"	8' 6"	11' 2"	7' 5"	6,535	1,075	9,500	2,965	86	39	39	5-6
277	32' 0"	8' 6"	11' 2"	7' 5"	TBD	TBD	TBD	TBD	112**	39	39	5-6

Some specs at the time of print may include estimates, for the most updated information, please visit Jayco.com

**Indicates split tanks

JAY FLIGHT OCTANE



TRAVEL WITH CONFIDENCE • NO ONE OFFERS A BETTER WARRANTY

At Jayco, we build our RVs to handle every adventure, then back them with our industry-leading 2+3 limited warranty. Our 2-year limited warranty has you covered for 2 camping seasons. That's 730 days. In addition, our 3-year structural limited warranty has you covered for 3 camping seasons or 1,095 days. You won't find a better limited warranty in the business, because the only strings that we attach are those that deliver the ultimate in reliability. That's the Jayco difference. So go explore. For a copy of our 2-year limited + 3-year limited structural warranty with complete terms and conditions, please contact your local Jayco dealer.



Scan QR code for specification definitions



Generations of family fun.